

# Technical data sheet

## In-concrete box for installation units of nominal size 9

Item number: 7399852



In-concrete box for duct height 48 mm, prepared for duct widths 250 and 350 mm.

With four adjustable placements for height-adjustment units.

The integrated lined body can be adjusted to a maximum of 65 mm for compensating screed work.



|           |                  |
|-----------|------------------|
| <b>St</b> | Steel            |
| <b>FS</b> | Strip galvanized |

### Master data

|                                    |                           |
|------------------------------------|---------------------------|
| Item number                        | 7399852                   |
| Type                               | IBD 35048 9               |
| Description 1                      | In-concrete box           |
| Description 2                      | for GES9                  |
| Manufacturer                       | OBO                       |
| Dimension                          | 440x440x145               |
| Material                           | Steel                     |
| Surface                            | Strip galvanized          |
| Surface standard                   | DIN EN 10346              |
| Smallest sales unit                | 1                         |
| Unit of quantity                   | Piece                     |
| Weight                             | 872.5 kg                  |
| Weight unit                        | kg/100 pc.                |
| CO2 Footprint (GWP) Cradle-to-Gate | 30,5272 kg CO2e / 1 Piece |

# Technical data sheet

In-concrete box for installation units of nominal size 9

Item number: 7399852



## Dimensions

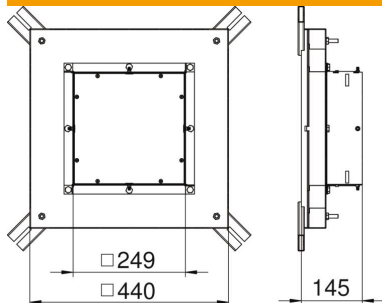

|             |        |
|-------------|--------|
| Height      | 145 mm |
| Dimension h | 145 mm |

## Technical data

|   |        |
|---|--------|
| Number of installable devices                     | 12     |
| Floor plate                                       | yes    |
| Seal installation option                          | no     |
| Installation opening for on-floor tank            | no     |
| Installation opening for flush-mount unit         | Square |
| Decouplable                                       | no     |
| For pipe connection                               | no     |
| Suitable for screed-flush closed underfloor ducts | no     |
| Suitable for screed-covered underfloor ducts      | yes    |
| Suitable for underfloor ducts                     | yes    |
| Trunking width, max.                              | 350 mm |
| Trunking width, min.                              | 250 mm |
| Duct height, min.                                 | 48 mm  |
| Nominal size for device installation units        | 9      |